

# PREFABRICATED CEILING —

8.9

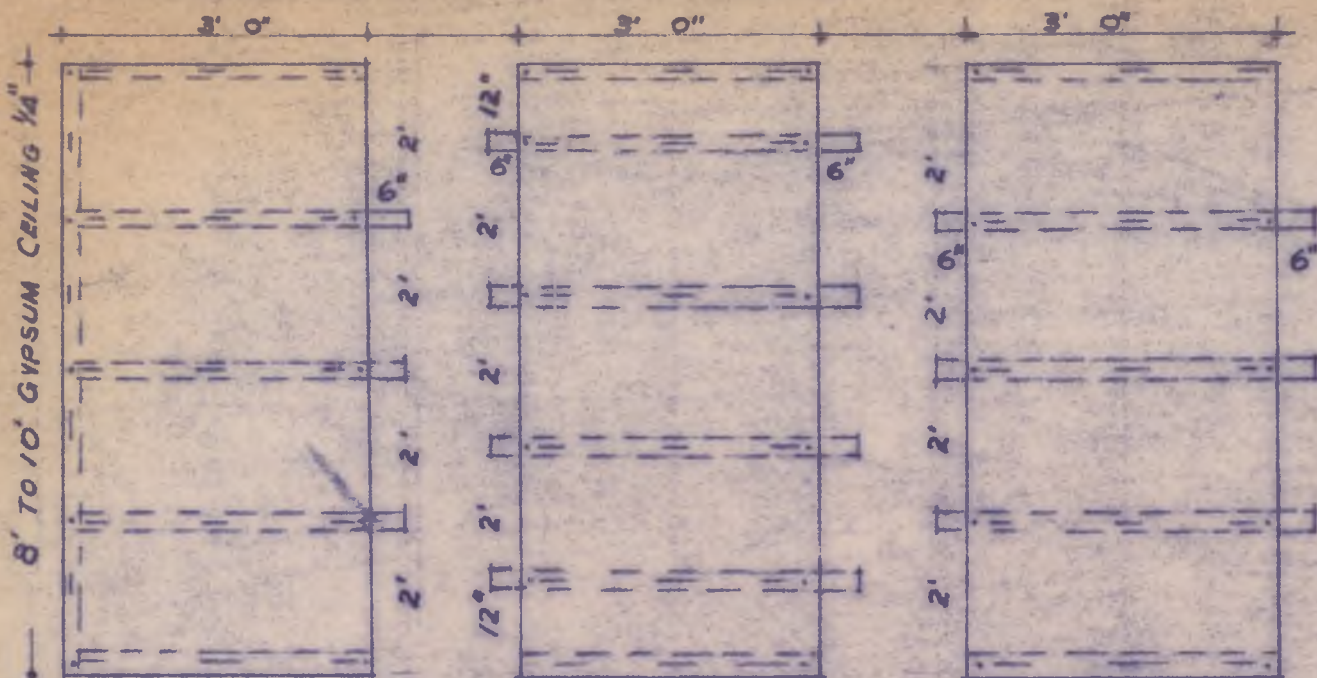

TYPE (A)  
FOR CORNER

TYPE (B)  
INTERMEDIATE PANELS TO BE ALTERNATED

TYPE (C)

ROOF TRUSSES TO BE 3' 0" CCS. WITH BOTTOM TIE BEAM DEAD LEVEL.

Ceiling Panels to be STAPLED TO 1 1/2 x 1 1/2 BRANDING IN 3 spots viz. in Centre and 4" FROM ENDS OF GYPSUM PANEL. along 3' 0" WIDTH AND IN 4 spots along 8ft length prior to ERECTION.

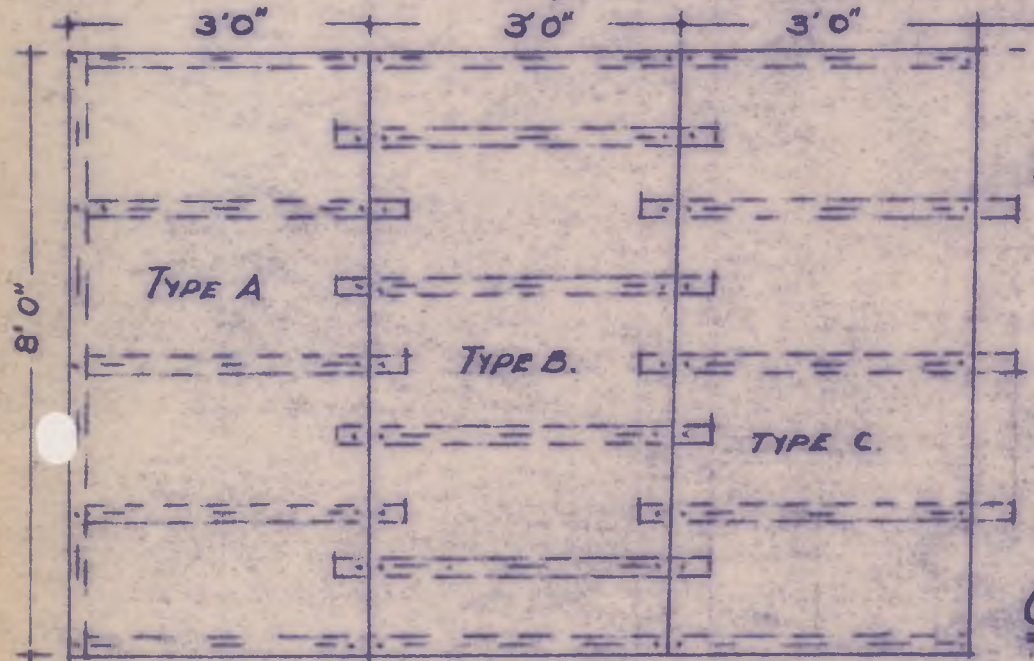

## STAPLING NOTE

Staples to be — — — —  
 TYPE A TO HAVE 19 STAPLES  
 " B. 00 18 "  
 " C. 00 15 "

## CEILING PLAN



1/4" x 8' 0" GYPSUM PANELS WITH STAPLED BRANDING TO BE BUTTED AT 3' 0" CENTRE

EACH PANEL TO BE NAILED 3/16" FROM BOUND. PANEL EDGE THRU BRANDING INTO TRUSS.

3" COVE (NOT SHOWN) TO BE NAILED TO CORNER.

COVER STRIP (NOT SHOWN) TO BE 2 x 1/4" GYPSUM

ALTERNATIVELY BUTT JOINTS IN PANELS TO BE FILLED WITH RHINO BOND TO GIVE SMOOTH SURFACE FINISH.

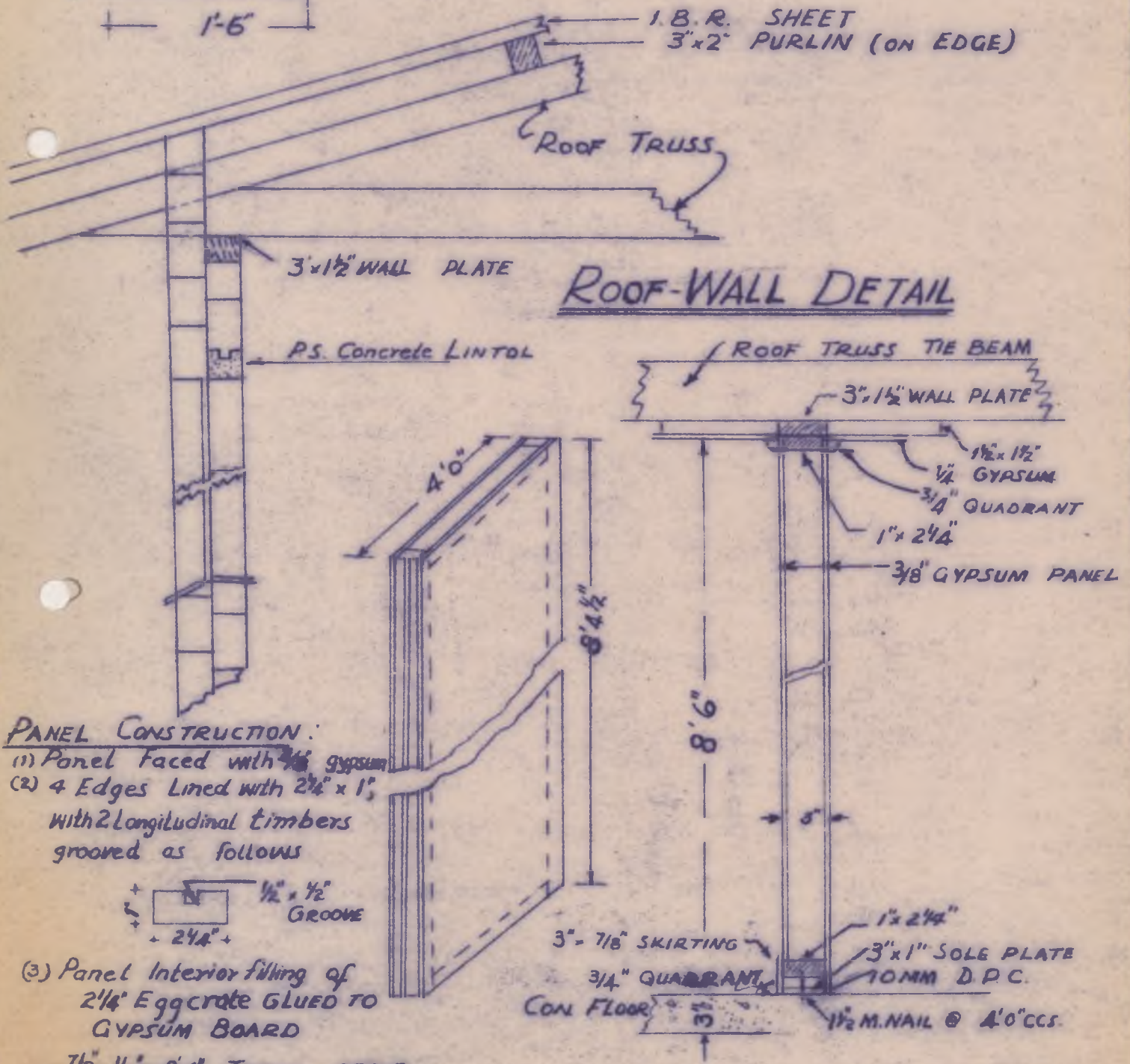
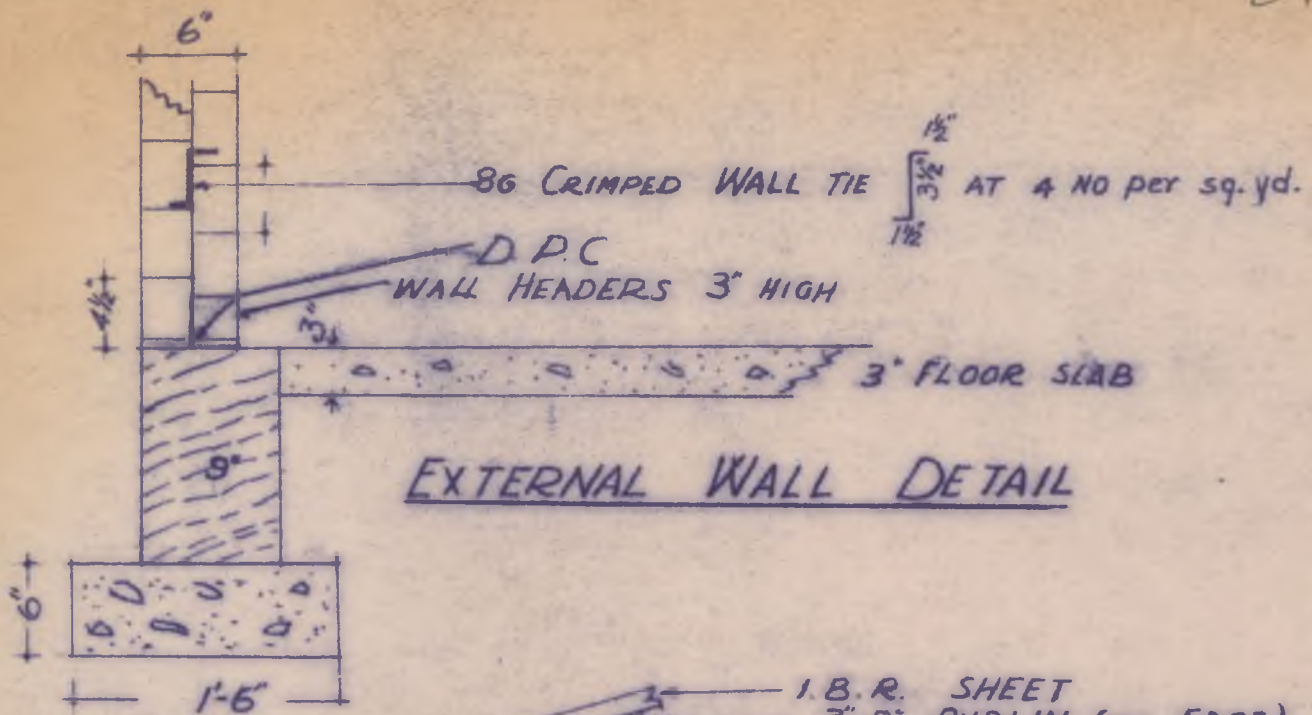

PANEL CONSTRUCTION:

- (1) Panel Faced with 3/8" gypsum
- (2) 4 Edges Lined with 2 1/4" x 1" with 2 longitudinal timbers grooved as follows

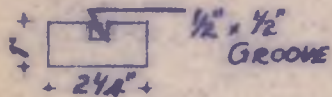

- (3) Panel Interior filling of 2 1/4" Eggcrete GLUED TO GYPSUM BOARD

- (4) 7/8" x 1/2" x 8'4" TONGUE STRIP

- PANEL DETAIL - WITH FIXING TO ROOF & FLOOR.

**Collection Number: A1434**

**Colin Goodman Papers, 1930-1972**

**PUBLISHER:**

*Publisher:- Historical Papers Research Archive*

*Location:- Johannesburg*

©2014

**LEGAL NOTICES:**

**Copyright Notice:** All materials on the Historical Papers website are protected by South African copyright law and may not be reproduced, distributed, transmitted, displayed, or otherwise published in any format, without the prior written permission of the copyright owner.

**Disclaimer and Terms of Use:** Provided that you maintain all copyright and other notices contained therein, you may download material (one machine readable copy and one print copy per page) for your personal and/or educational non-commercial use only.

People using these records relating to the archives of Historical Papers, The Library, University of the Witwatersrand, Johannesburg, are reminded that such records sometimes contain material which is uncorroborated, inaccurate, distorted or untrue. While these digital records are true facsimiles of paper documents and the information contained herein is obtained from sources believed to be accurate and reliable, Historical Papers, University of the Witwatersrand has not independently verified their content. Consequently, the University is not responsible for any errors or omissions and excludes any and all liability for any errors in or omissions from the information on the website or any related information on third party websites accessible from this website.

This document is part of a collection held at the Historical Papers Research Archive, The Library, University of the Witwatersrand, Johannesburg, South Africa.